

Wing Screws DIN 316 brass

B

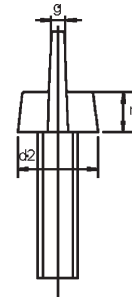
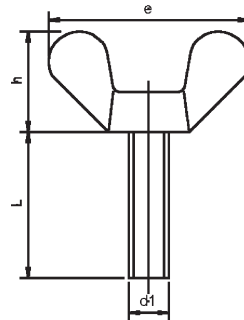

		DIMENSIONS					
HEAD	M	M4	M5	M6	M8	M10	M12
	D	8,0	8,5	10,0	11,5	15,5	18,5
	e	20,0	25,0	31,5	37,0	49,5	63,5
	g	1,5	1,9	1,9	2,4	4,0	4,5
	h	9,5	12,0	16,0	19,0	24,0	32,3
	m	3,9	5,3	6,5	8,3	10,0	12,0
		VE					
LENGTH	8	200	200	200	-	-	-
	10	200	200	200	100	-	-
	12	200	200	100	100	-	-
	16	200	200	100	100	50	20
	20	200	200	100	100	50	20
	25	200	200	100	100	50	20
	30	200	100	100	100	50	20
	35	200	100	100	100	50	20
	40	100	100	100	50	50	20
	45	-	100	100	50	50	20
	50	-	100	100	50	20	20
	60	-	100	100	50	20	20
	70	-	-	100	50	20	20
80	-	-	100	50	20	20	

PACKING (VE): Commercial standard or after customer's request
MATERIAL: Brass (MS) 2.0401 acc. to DIN 17660 self colour, nickel plated acc. to DIN EN ISO 4042, other surfaces on request
TOLERANCE: Metric thread 6 h / DIN 13-20
DIMENSIONS: The above mentioned dimensions are indicate only. They correspond to the average allowed during the production process.

