

THUMB SCREWS

CAST

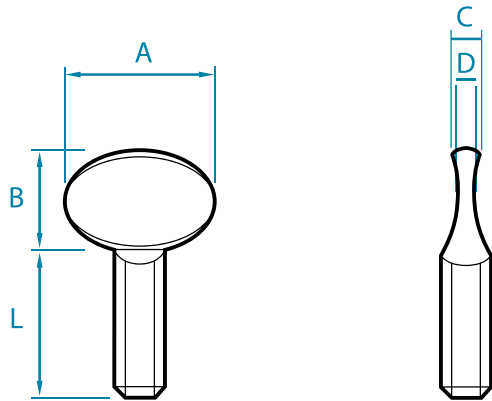

DIMENSIONS					
HEAD		M5	M6	M8	M10
	A	20,5	23,5	27,5	36,0
	B	15,5	16,0	19,0	25,0
	C	3,5	4,5	4,5	6,5
	D	2,0	2,5	2,5	3,0
LENGTH	8	-	-	-	-
	10	200	200	-	-
	12	200	200	100	-
	16	200	100	100	-
	20	200	100	100	50
	25	-	100	100	50
	30	-	100	100	50
	35	-	-	-	-
	40	-	-	50	50
	50	-	-	50	20
	60	-	-	-	-

PACKAGING: Standard or according to customer specification

MATERIAL: Malleable cast iron, EN-GJMB-350-10 as per DIN EN 1562, bright, galvanised, nickel-plated as per DIN EN ISO 4042, further finishes on request

TOLERANCE: Metric thread 6 H (bright 6 g) as per DIN EN ISO 965-1

All of the dimensions stated above are approximate and may deviate both upwards and downwards.

THUMB SCREWS

COLD FORMED

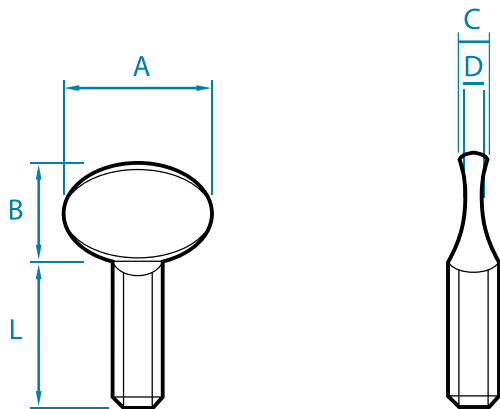

DIMENSIONS						
HEAD		M4	M5	M6	M8	M10
	A	11,2	14,0	16,5	22,0	26,0
	B	7,7	10,8	14,0	17,0	19,0
	C	2,6	3,1	4,1	4,7	6,0
LENGTH	8	-	200	200	-	-
	10	200	200	200	100	-
	12	200	200	200	100	-
	15	200	200	100	100	-
	20	200	200	100	100	50
	25	200	200	100	100	50
	30	200	200	100	100	50
	35	-	-	100	100	50
	40	-	-	100	50	50
	50	-	-	100	50	20
	60	-	-	-	50	20

PACKAGING: Standard or according to customer specification
 MATERIAL: Steel bright, galvanised, nickel-plated as per DIN EN ISO 4042, further finishes on request
 TOLERANCE: Metric thread 7 H (bright 7 g) as per DIN EN ISO 965-1

All of the dimensions stated above are approximate and may deviate both upwards and downwards.