

CHANNEL NUTS

TOOTHED FOR STRUT MOUNTING RAILS

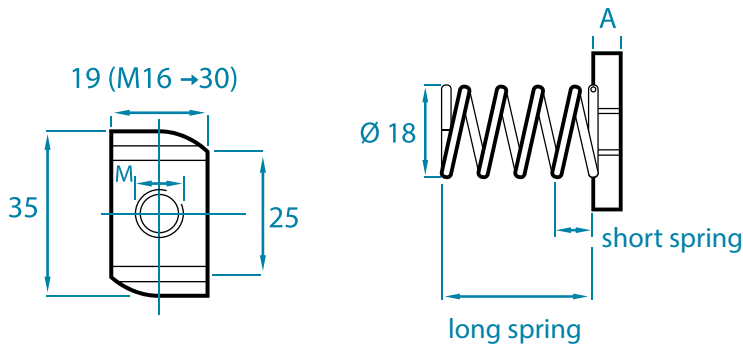

	without spring		short spring		long spring		top nut	
	A		A		A		A	
M 6	6	100 / 400	6	100 / 400	6	100 / 400	6	100 / 400
M 8	6	100 / 400	6	100 / 400	6	100 / 400	6	100 / 400
M 10	8	100 / 400	8	100 / 400	8	100 / 400	8	100 / 400
M 12	9	100 / 400	8	100 / 400	9	100 / 400	9	100 / 400
M 16	10	100 / 400	-	-	-	-	-	-

Load values Channel nuts

The following load values apply for BTS channel nuts in steel and stainless steel for strut mounting rails in combination with a threaded rod of strength class 4.6

exposed to static load. The maximum load value of the mounting rail used is to be observed. BTS provides no guarantee for the load value of the mounting rail.

Dimension	F3 [kN]	F4 [kN]	T [Nm]
M 6	5	1	3,5
M 8	6	2,4	8,4
M 10	7	3,5	17
M 12	7	4	29
M 16	12	4	71

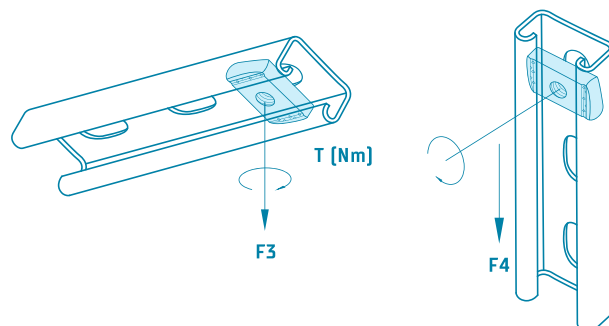

» On request: hot-dip galvanised channel nuts with oversize, individual tothing and tooth distance, special thicknesses
 » As complete special part, also for other profile sizes

MATERIAL: Steel, minimum hardness 130 HB galvanised as per DIN EN ISO 4042, hot-dip galvanised, stainless steel A4, further finishes on request.

All of the dimensions stated above are approximate and may deviate both upwards and downwards.

CHANNEL NUTS

FOR PROFILE RAILS WITH STRAIGHT FLANGES

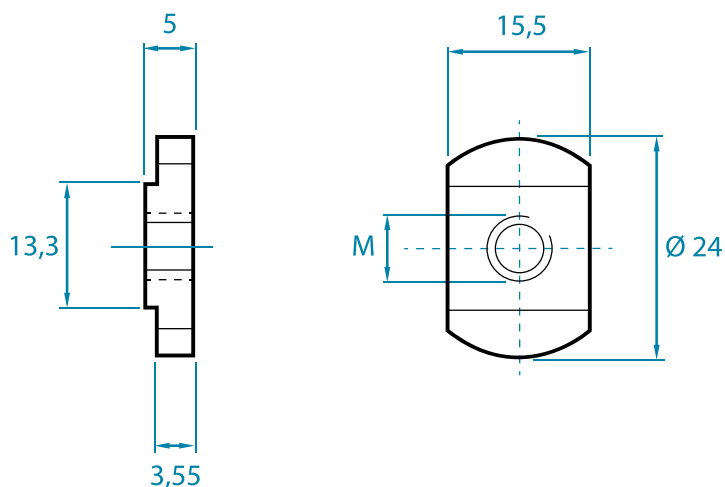

Channel nuts without spring

	Length	Breite	
M 6, 8, 10	24,0 mm	15,5 mm	100 / 1800

MATERIAL: Steel, min. hardness 130 HB, galvanised as per DIN EN ISO 4042, further finishes on request

Mounting Channel Nuts DIN 3015

LIGHT SERIES: For the securing of pipe and hose clamps in mounting rails M6, 1/4", M8, 5/16"

HEAVY SERIES: For the securing of pipe and hose clamps in mounting rails GMV10 + 12, M10, M12



MATERIAL: Malleable cast iron, EN-GJMB-350-10 as per DIN EN 1562, bright, galvanised, nickel-plated as per DIN EN ISO 4042, on request stainless steel A2, A4, pickled, passivated

All of the dimensions stated above are approximate and may deviate both upwards and downwards.

CHANNEL NUTS

WITH FIXING AID TOOTHED FOR STRUT MOUNTING RAILS

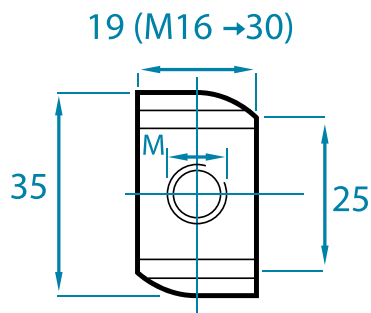

Channel nut with fixing aid

	Thickness (mm)	
M6	6	100 / 400
M8	6	100 / 400
M10	8	100 / 400
M12	9	100 / 400

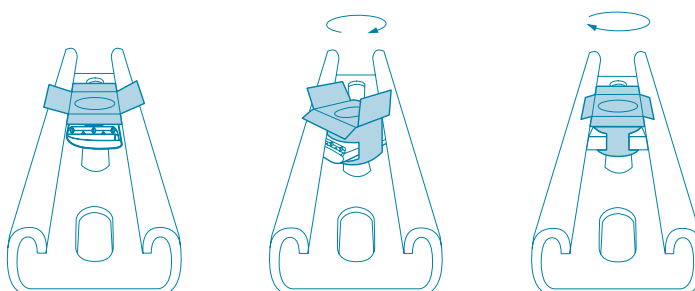

Load values Channel nuts

The following load values apply for BTS channel nuts in steel and stainless steel for strut mounting rails in combination with a threaded rod of strength class 4.6 exposed to static load.

Dimension	F3 [kN]	F4 [kN]	T [Nm]
M 6	5	1	3,5
M 8	6	2,4	8,4
M 10	7	3,5	17
M 12	7	4	29
M 16	12	4	71

“Fixing at the flick of a wrist”

The maximum load value of the mounting rail used is to be observed. BTS provides no guarantee for the load value of the mounting rail

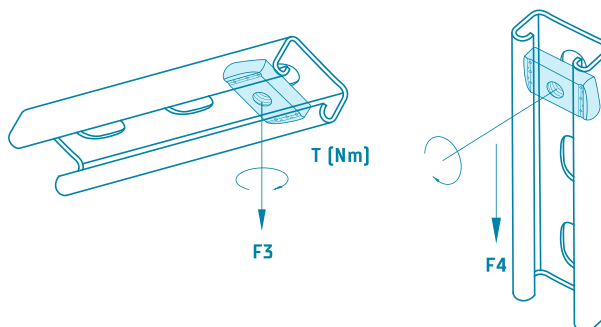

- » One type for all strut rails
- » Simple and fast mounting with one hand
- » Holds after rotation in the rail, ideal for vertically-installed rails
- » Remains easy to move after mounting
- » No jamming of the spring in perforated rails
- » On request: hot-dip galvanised channel nuts with oversize, individual toothing /tooth spacing, special thicknesses, plastic in RAL colour on customer request
Complete special part, also for other profile sizes

MATERIAL: Steel channel nut, min hardness 130 HB galvanised as per DIN EN ISO 4042, polypropylene (plastic) fixing aid, grey colour as per RAL7040 stainless steel A4, further finishes on request

All of the dimensions stated above are approximate and may deviate both upwards and downwards.