

# HAMMER-HEAD BOLTS

## ONE-PIECE MODEL FOR PROFILES WITH STRAIGHT FLANGES

Type
20/12
28/15
38/17
41/22

- » As standard for profiles: 20/12 and 28/15 with and without square, 38/17 with square, 41/22 without square
- » On request as complete special part, according to customer drawing or sample, also for other profile sizes



# HAMMER-HEAD BOLTS

## ONE-PIECE MODEL FOR C-PROFILES

Type
40/22
50/30
72/48

- » As standard for profiles: 40/22, 50/30, 72/48
- » As complete special part, according to customer drawing or sample, also for other profile sizes



MATERIAL: Steel 4.6 or 8.8 galvanised as per DIN EN ISO 4042 or hot-dip galvanised, stainless steel A2 or A4

PACKAGING: Standard or according to customer specification

Optionally with or without hex nut as per DIN 934 and washer.

All of the dimensions stated above are approximate and may deviate both upwards and downwards.

# HAMMER-HEAD BOLTS

## TWO-PIECE MODEL FOR STRUT MOUNTING RAILS

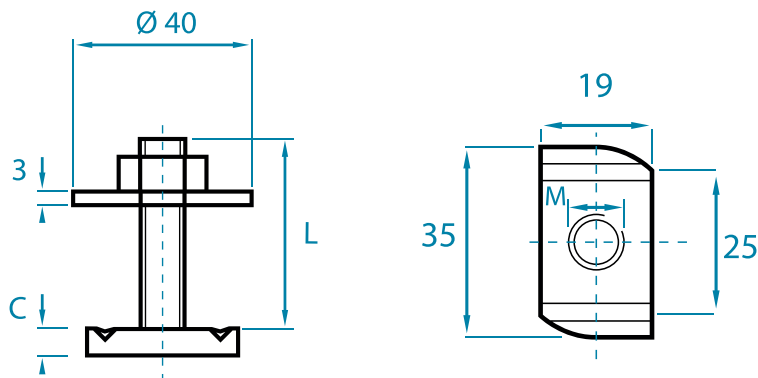

### DIMENSIONS /

LENGTH [L]		M 8	M 10	M 12
	C		6 mm	8 mm
20		50	-	-
30		50	50	50
40		50	50	50
50		50	50	-
60		50	50	50
80		50	50	50
90		-	50	-
100		-	50	50

### Load values for hammer-head bolts

The following load values apply for BTS hammer-head bolts in steel and stainless steel for strut mounting rails in combination with a threaded rod of strength class 4.6

[A4-50] exposed to static load. The maximum load value of the mounting rail used is to be observed. BTS provides no guarantee for the load value of the mounting rail.

Dimension	F3 [kN]	F4 [kN]	T [Nm]
M 6	5	1	3,5
M 8	6	2,4	8,4
M 10	7	3,5	17
M 12	7	4	29
M 16	12	4	71

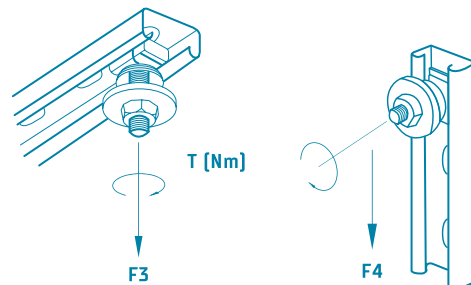

- » Pre-mounted with U washer and hex nut DIN 934
- » On request: hot-dip galvanised top screws, individual tothing and tooth distance, special thicknesses, special lengths
- » Complete special part, also for other profile sizes

**MATERIAL:** Steel, minimum hardness 130 HB galvanised as per DIN EN ISO 4042, stainless steel A4, further finishes on request

All of the dimensions stated above are approximate and may deviate both upwards and downwards.

# TOPSCREWS

## TWO-PIECE MODEL FOR STRUT MOUNTING RAILS

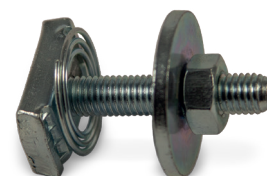
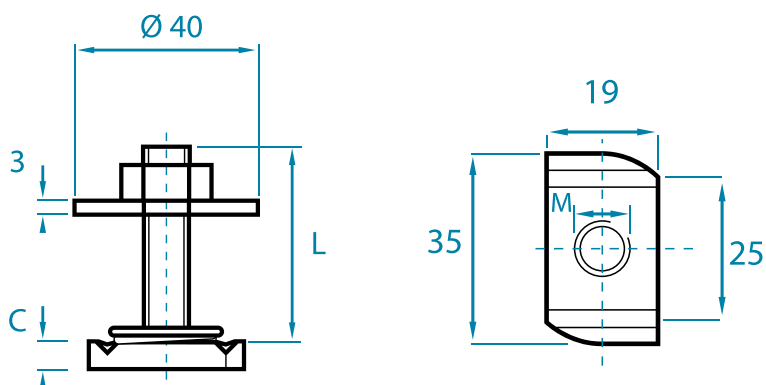

### DIMENSIONS /

LENGTH		M 8	M 10	M 12
	C		6 mm	8mm
30		50	50	50
40		50	50	50
50		50	50	-
60		50	50	-

### Product benefits:

1. Time savings via pre-assembled system in various lengths
2. Clamps in the mounting rail, making it ideal for vertical installations
3. Easily moved within the rail
4. No jamming of the spring in perforated mounting rails
5. Just one system for all strut mounting rails

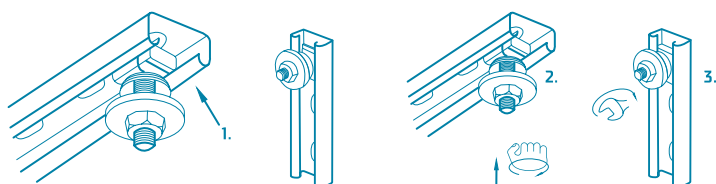

### Mounting:

1. Guide top screw through the opening in the profile.
2. Press against top screw whilst simultaneously rotating by 90°.
3. Finally, tighten hex nut.

Dimension	F3 [kN]	F4 [kN]	T [Nm]
M 6	5	1	3,5
M 8	6	2,4	8,4
M 10	7	3,5	17
M 12	7	4	29
M 16	12	4	71

### Load values

The following load values apply for BTS top screws in steel and stainless steel for strut mounting rails in combination with a threaded rod of strength class 4.6 exposed to static load. The maximum load value of the mounting rail used is to be observed. BTS provides no guarantee for the load value of the mounting rail.

» Pre-mounted with U washer and hex nut DIN 934

» On request: hot-dip galvanised top screws, individual tothing and tooth distance, special thicknesses, special lengths

» Complete special part, also for other profile sizes

See data sheet for head dimensions, toothed channel nuts for strut mounting rails.

MATERIAL: Steel, minimum hardness 130 HB galvanised as per DIN EN ISO 4042, stainless steel A4, further finishes on request.

All of the dimensions stated above are approximate and may deviate both upwards and downwards.

# HAMMER-HEAD BOLTS

## FOR PROFILES WITH STRAIGHT FLANGES TYPE 27/18 & 28/30

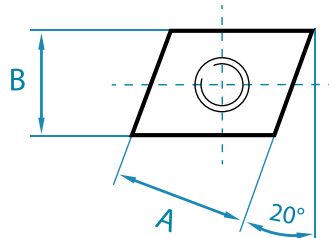
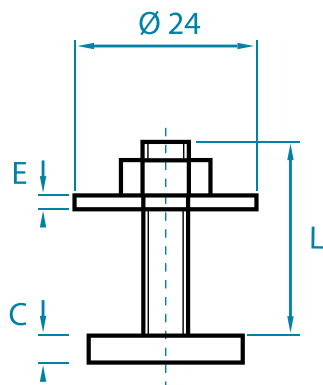

DIMENSIONS M8xL	A	B	C	D	E	
M8x30	21	16	5	24	2	50
M8x40	21	16	5	24	2	50
M8x50	21	16	5	24	2	50
M8x80	21	16	5	24	2	50

- » Fully mounted with Din 9021 U washer and Din 934 hex nut
- » On request: special parts, also for other profile sizes

MATERIAL: Steel, galvanised, nickel-plated as per DIN EN ISO 4042, further finishes on request

All of the dimensions stated above are approximate and may deviate both upwards and downwards.