

BEAM CLAMPS

For securing to beams without drilling or welding for: sprinkler systems, heating, ventilation and air-conditioning systems, acoustics systems, electrical, piping and sanitation fittings, engineering and steel structures.

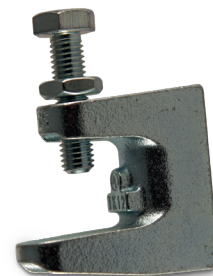
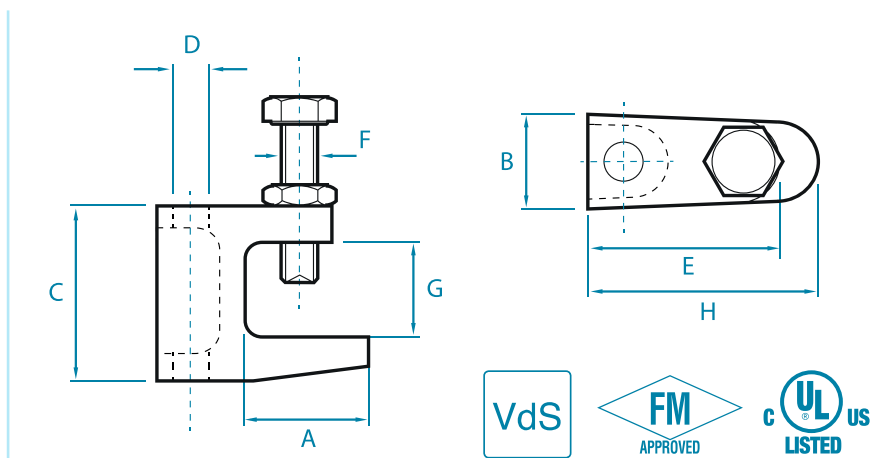

Fig. shows TK12

The raised marking serves as anti-twist protection when tightening the retaining screw and is protected by internationally registered design DM/0081575!

Model	A (approx. mm)	B (approx. mm)	C (approx. mm)	D	E (approx. mm)	F (approx. mm)	G (approx. mm)	H (approx. mm)	Weight (approx. g)	Rated load (N)	Certificates
TKN 8	21	19	35	M8 / \varnothing 9	35	M8	18	38	85	1200	VdS, UL
	21	19	35	M6 / \varnothing 7	35	M8	18	38	85	1200	UL
TK 10	29	21	45	M8 / \varnothing 9	41	M10	23	50	145	2500	VdS, UL
	29	21	45	M6 / \varnothing 7	41	M10	23	50	145	2500	UL
TKN 10	23	21	42	M10 / \varnothing 11	41	M10	20	44	143	2500	VdS, UL, FM
TK 12	32	23,5	54	M12 / \varnothing 13	48	M10	26	58	216	3500	VdS, UL, FM
TK 16	26	29,5	58	M10, M12, M16 / \varnothing 11, \varnothing 13, \varnothing 17	55	M12	28	58	335	5500	VdS, UL, FM
TKC	44	55	78	\varnothing 13	55	M12	45	71,5	551	3500	-

- » Where possible, VdS, FM and UL certified
- » Full range for M6 – M16 threaded rods from stock
- » Inch thread on request
- » Clamping widths from 18 – 45 mm
- » Please also note "Product benefits" information sheet

PACKAGING:	50 pcs in box or according to customer specification
MATERIAL:	Malleable cast iron body, general tolerances as per DIN EN ISO 8062-3 CT8
SCOPE OF SUPPLY:	Mounted with DIN 933 8.8 hex bolt, end with cup point (CP) as per EN ISO 4753 and DIN 439 lock nut
SURFACE FINISH:	Galvanised as per DIN EN ISO 4042, on request hot-dip galvanised as per DIN EN ISO 1461, or also coated with zinc flake (e.g. Geomet)

All of the dimensions stated above are approximate and may deviate both upwards and downwards.

BEAM CLAMPS

STAINLESS STEEL

For securing to beams in the following areas: sprinkler systems, heating, ventilation and air-conditioning systems, acoustics systems, electrical, piping and sanitation fittings, engineering and steel structures.

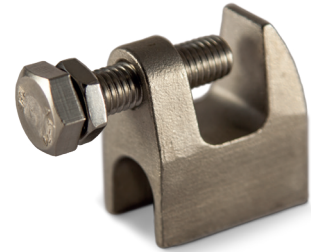
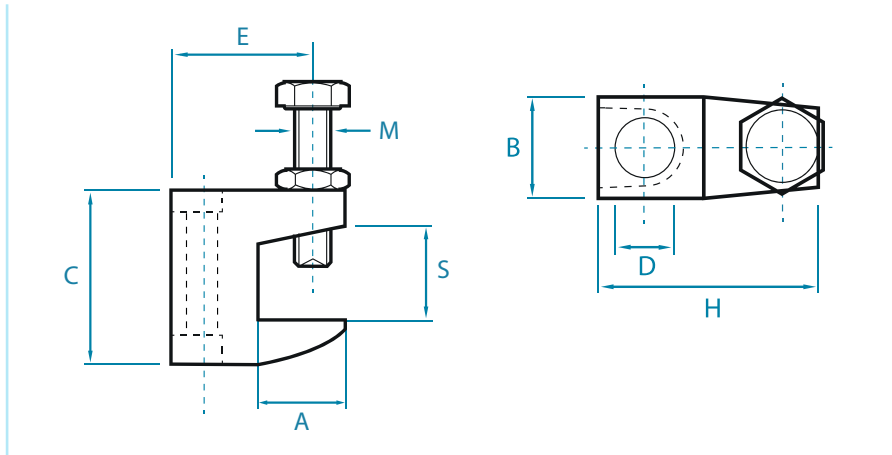

Rated load [N]	For threaded rods	Dimensions [mm]							
		S	A	B	C	D	E	H	
1000	M8	0-16	21,5	21,0	38,0	9,0	34,0	41,5	50
1000	M10	0-16	21,5	21,0	38,0	11,0	34,0	41,5	50
1300	M12	0-16	21,5	21,0	38,0	13,0	34,0	41,5	50

- » With DIN 933 M10x40 retaining screw with cup point (CP) and DIN 439 hex nut
- » Marking "9mm", "11mm" or "13mm" and material

MATERIAL: Stainless steel A2 [1.4301] or A4 [1.4401]

SCOPE OF SUPPLY: Mounted with DIN 933 hex bolt, end with cup point (CP) as per EN ISO 4753 and DIN 439 lock nut

All of the dimensions stated above are approximate and may deviate both upwards and downwards.

BEAM CLAMPS

PRODUCT BENEFITS

Product benefits of certified beam clamps:

- » Enable use in certified fixed sprinkler systems
- » Load values assured by independent institutes
- » Cup point end to prevent sideways movement from the T-beam
- » In the case of beam clamps with through bores a simple height adjustment can also be undertaken following mounting
- » Pre-assembly with threaded rod and lock nut possible

Further product benefits of BTS beam clamps:

- » Malleable cast iron body, made in Germany
- » Prior to processing, inspection of all cast parts for visible bubbles
- » Retaining screws and lock nuts of all beam clamps can be tightened using just one open-ended wrench
- » Type TK and TKN are certified for both "tensile direction against the retaining screw" and "tensile direction against support" mounting
- » Additional UL certificate for type TK and TKN for use in electrical installations
- » Elevated marking to prevent twisting of the beam clamps during tightening of the retaining screw (internationally registered design DM/0081 575)
- » Complete warehouse programme for threaded rods from M6 to M16
- » Clamping widths from 18-45 mm available in stock
- » Galvanised and hot-dip galvanised as standard

On request:

- » 3.1 Certification of German origin for cast
- » Tipped end
- » Beam clamps with inch thread
- » Special finishes and special packaging

Also available in A4 (see separate product sheet)

All of the dimensions stated above are approximate and may deviate both upwards and downwards.

BEAM CLAMPS

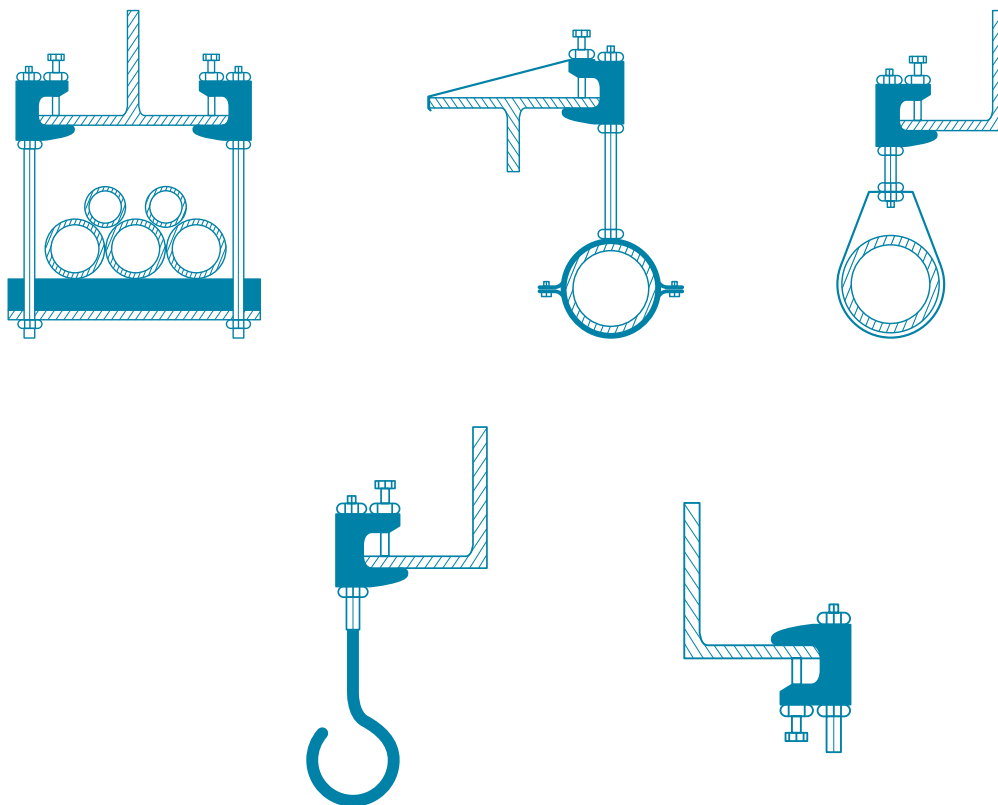

Our type TK and TKN beam clamps can be mounted with the tensile direction against the retaining screw or against the support. Please see our mounting instructions for further information.

SECURING STRAPS

The use of securing straps for beam clamps is compulsory for > DN65 pipes under VDS regulations. All beam clamps can be secured with a securing strap against sideways slipping from the beam. Responsible authority regulations are to be observed.

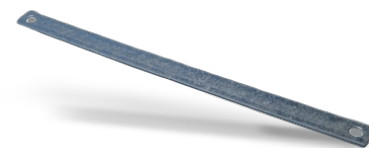

Fits	Length (mm)	Breite (mm)	Dicke (mm)	Loch-ø (mm)	
TKN 8, TK 10, TKN 10, TK 12	350	25	3	10,5 / 12,5	12
TK 16	400	40	3	12,5 / 17,0	12

MATERIAL: Steel

SURFACE FINISH: galvanised as per DIN EN ISO 4042

All of the dimensions stated above are approximate and may deviate both upwards and downwards.